



OWAcliq – exposed, demountable

OWAlifetime collection

OWA

System S 3 cliq/S 3a cliq | Exposed, demountable

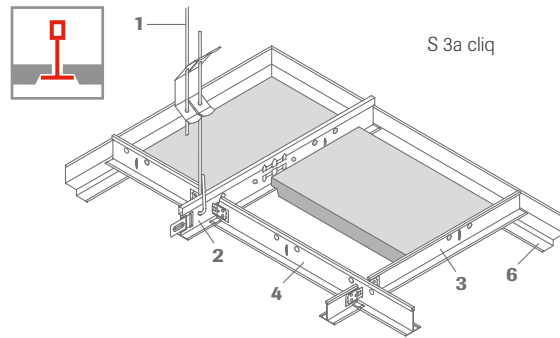
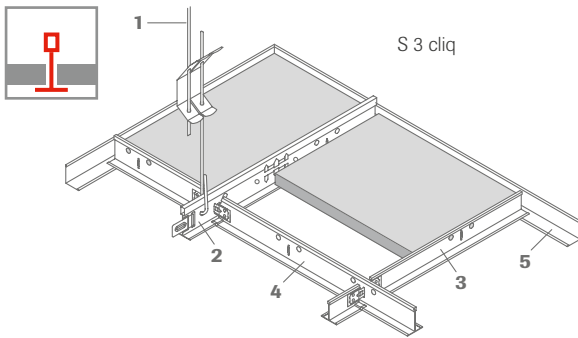

Section dimensions:

Main tee
cliq-24-MR

Cross tee long
cliq-24-CT

Cross tee short
cliq-24-CT

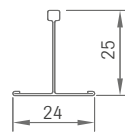
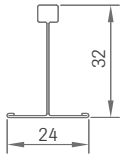
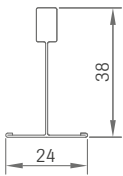

- 1 Hanger
- 2 Main tee cliq-24-MR, slotted every 100 mm, 156.25 mm or 6"
- 3 Cross tee cliq-24-CT, length 600 mm, 625 mm or 2'
- 4 Cross tee cliq-24-CT, length 1200 mm, 1250 mm or 4'
- 5 Cross tee cliq-24-CT, length 300 mm, 312.5 mm or 400 mm
- 6 Wall angle no. 50G
- 7 Shadow wall angle no. 50/15G
- 8 Contura block no. 42/24
- 9 Module size

Cross-section of system S 3 cliq:

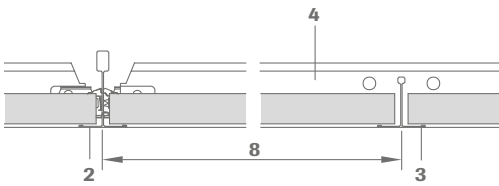

Cross-section of system S 3a cliq:

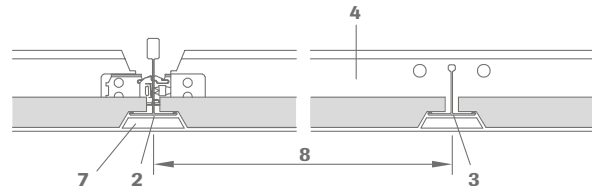

Section of system S 3 cliq:

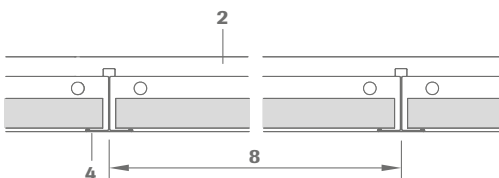

Section of system S 3a cliq:

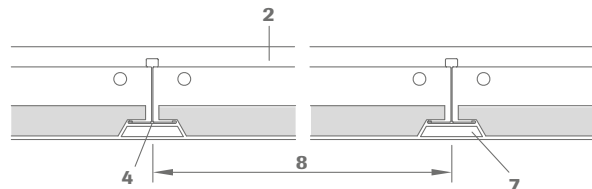

Technical data | Mineral tiles

Dimensions

Module sizes: 600 x 600 mm, 610 x 610 mm, 625 x 625 mm, 1200 x 600 mm, 1220 x 610 mm, 1250 x 625 mm
widths: 300 mm, 305 mm, 312.5 mm, 400 mm | lengths: 1200 mm, 1220 mm, 1250 mm

Edge details

S 3 cliq



S 3a cliq



Thickness

Approx. 15 mm and 20 mm (OWAcoustic® premium)
also suitable for OWAcoustic® smart

Resistance to fire

A2-s1,d0 in accordance with EN 13501-1

Reaction to fire

See OWA brochure no. 9500 eu e

Metal suspensions

All metal components listed are galvanized steel or white coated galvanized steel respectively.

Suspension depth

Depending on the existing soffit, a minimum suspension height of 75 – 100 mm is required.
For ease of access the minimum recommended suspension height is ≥ 120 mm.

Wall angle details:

System S 3 cliq

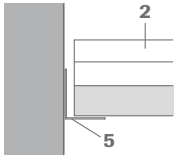

System S 3a cliq

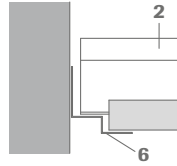

For more information about installation, see OWA-Installation Guide 9801 e.

Installation examples:

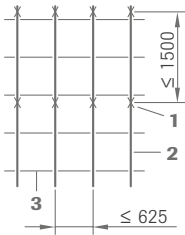

Module 625 x 625 mm

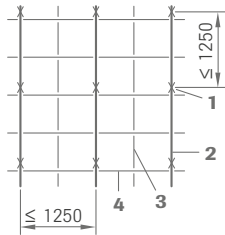

Module 625 x 625 mm

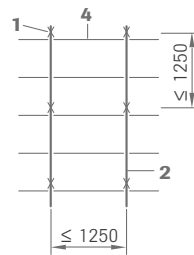

Module 1250 x 625 mm

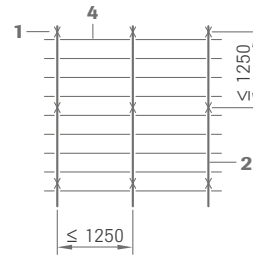

Module 1250 x 312.5 mm

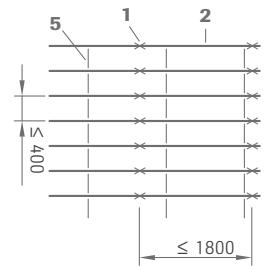

Module 1250 x 400 mm

Light fixtures:

OWA can supply compatible light fixtures for this system.

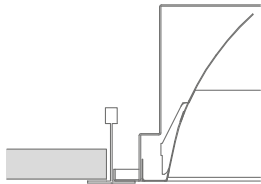

For details of performance, installation and fire resistance please see OWA-brochure no. 9630 e and OWA-Installation Guide no. 9801 e.



Advantages at a glance:

- easy installation of main tees and cross tees
- cross tees simply snap into place
- audible „click“ confirms location
- tested fire resistance
- load-bearing capacity tested in accordance with European and US standards
- proven OWA quality
- available worldwide via the global OWA distribution network
- fire resistance certified as a complete system with OWAacoustic® panels
- meets LEED® standard regarding recyclability
- meets criteria for earthquake safety in accordance with ASTM E580 (see the separate leaflet S 3 cliq seismic resistance)
- can be used with other panel products



Material requirements per m² (approximations):

module sizes in mm

No.	Description	600 x 600	610 x 610	625 x 625	1200 x 300	1200 x 600	1220 x 610	1250 x 312.5	1250 x 625	1250 x 400
12/.../2	Hanger	0.7 piece	0.7 piece	0.7 piece	0.7 piece	0.7 piece	0.7 piece	0.7 piece	0.7 piece	0.7 piece
cliq-24-MR	Main tee	0.83 m	0.82 m	0.8 m	0.83 m	0.83 m	0.82 m	0.8 m	0.8 m	2.5 m
cliq-24-CT	Cross tee short	0.83 m	0.82 m	0.8 m	-	-	-	-	-	0.8 m
cliq-24-CT	Cross tee long	1.66 m	1.64 m	1.6 m	3.33 m	1.66 m	1.64 m	3.2 m	1.6 m	
50G	Wall angel (S 3 cliq)	Depending on room size and shape								
50/15G	Shadow wall angle (S 3a cliq)	Depending on room size and shape								

Weight per m²:

	600 x 600	610 x 610	625 x 625	1200 x 300	1200 x 600	1220 x 610	1250 x 312.5	1250 x 625	1250 x 400
Suspension system approx.	1.13 kg/m ²	1.17 kg/m ²	1.09 kg/m ²	1.47 kg/m ²	0.90 kg/m ²	0.89 kg/m ²	1.42 kg/m ²	1.87 kg/m ²	1.16 kg/m ²
Tile 15 mm. approx.	4.5 kg/m ²	4.5 kg/m ²	4.5 kg/m ²	4.5 kg/m ²	4.5 kg/m ²	4.5 kg/m ²	4.5 kg/m ²	4.5 kg/m ²	4.5 kg/m ²

System description:

OWAconstruct® system S 3 cliq and S 3a cliq

Quality requirements for mineral tiles:

OWAacoustic mineral tiles firmly bound with a primer coat on both sides. The tile is free from asbestos. No formaldehyde is added in the manufacturing process of the mineral tiles. The mineral wool used for the manufacture of the tile is bio-soluble. The criteria for non-classification as a carcinogenic substance in accordance with the Chemicals Prohibition Ordinance (Section 1 Appendix, Paragraph 23 biopersistent fibres) are met and guaranteed by the 'RAL seal of approval for mineral wool'. Verification of fitness for use according to EU CPR: CE marking and Declaration of Performance (DoP).

Mineral tiles accordance with DIN EN 13964 and DIN 18177.

Air permeability class: PM 1
Formaldehyde class: FH 1
Emission of VOC: TVOC 1

Installation should be carried out in accordance with the information contained in system leaflet S 3 cliq/S 3a cliq e and OWA-Installation Guide no. 9801 e. All components are CE labelled.

Component list:

OWAconstruct hanger no. 12/.../2
Main tee cliq-24-MR
Cross tee short cliq-24-CT
Cross tee long cliq-24-CT
Cross tee cliq-24-CT-300
Cross tee cliq-24-CT-312.5
Cross tee cliq-24-CT-400
OWAconstruct wall angle no. 50G
OWAconstruct shadow wall angle no. 50/15G
Contura plug no. 42/24

Green building materials: OWAconstruct® grid system scores according to LEED®

This OWAconstruct® suspension system is designed and produced by OWA and meets the current LEED® standards. As an environmentally friendly grid the materials used for production are completely recyclable.

OWAconstruct® is manufactured in accordance with the European standard EN 13964 and is 100 % recyclable.

In buildings trying to achieve LEED® accreditation, the recycled content of the building materials used must be at least 20 % (post-industrial + post-consumer). Where this figure is exceeded the maximum number of points according to the LEED® criteria can be attained.

OWA continually strive to achieve the optimum balance between the use of recycled materials, conservation of resources and the production of high quality performance products. We have now increased the post consumer recycled content of our grid to 23 %.

When calculated in accordance with LEED® criteria the post industrial recycled content is now 27 %.

The OWAconstruct grid production is continually monitored by both internal and external checks and the increase in recycled content has been achieved without sacrificing quality or performance.

* Post-industrial is the industrial waste from production. Post-consumer represents the end of product life, where the consumer can longer use the product for its intended use.

Product warranties

The information provided in this leaflet is based on the standards and data available at the time of publication. Any performance, warranties or guarantees provided, expressed or implied, are subject to the exclusive use of OWA components and the installation of those components in accordance with our recommendations. Failure to adhere to these conditions will result in the invalidation of any performance claims, warranties or guarantees and rejection of any liability. OWA reserves the right to make any technical improvements to the products, systems or services without prior notice. **All goods and services are supplied in accordance with our current Terms and Conditions of Sale.** Errors excepted!



Odenwald Faserplattenwerk GmbH

Dr.-F.-A.-Freundt-Straße 3 | 63916 Amorbach | Germany
tel +49 93 73.2 01-0 | info@owa.de
www.owa-ceilings.com

Brochure
S 3 cliq/S 3a cliq e
061800